

Safety Sasa generally specializes in providing products and services that help to protect workers and others from hazards in the workplace. These can include personal protective equipment (PPE) such as hard hats, safety glasses, earplugs, and respirators, as well as other types of equipment and training, consulting, and other services to help employers and employees understand and comply with relevant safety regulations and best practices.

Our Purpose

Provide products and services that help protect workers and others from hazards in the workplace. Our ultimate goal is to promote safety and reduce the risk of accidents and injuries in the workplace, thus leading to a more efficient and productive work environment.

Our Mission

Is to provide high-quality and reliable products and services that help protect workers and others from hazards in the workplace by promote a culture of safety in the workplace and to empower employees to take responsibility for their own safety and the safety of their co-workers.



Our Attitude

We are committed to customer satisfaction, innovation and excellence, safety advocacy and education.

PRODUCTS CATEGORIES

PPF SAFETY

FIRE SAFETY

LADDERS

BATHROOM SAFETY

SWIMMING SAFETY

MOBILITY AID & EMERGENCY PRODUCTS

TRAVELING SET PRODUCTS

OUTDOOR EQUIPMENTS

HEATERS

FLOOR SAFETY

HYGIENE

HOME-CARE PRODUCTS

PPE SAFETY



At Safety Sasa, our Personal Protective Equipment (PPE) Safety category encompasses a wide array of essential gear designed to shield workers and others from potential workplace hazards. From sturdy hard hats and protective eyewear to reliable earplugs and respirators, our PPE offerings are meticulously curated to meet stringent safety standards and ensure comprehensive protection in diverse work environments.

Our commitment to promoting safety in the workplace is evident in the quality and reliability of our PPE products. We understand the importance of equipping individuals with the necessary tools to mitigate risks and prevent injuries. By offering a comprehensive selection of PPE, we empower employers and employees alike to proactively address safety concerns and uphold regulatory compliance



MOBILITY AID & EMERGENCY PRODUCTS

We extend our commitment to workplace safety by offering a comprehensive range of Mobility Aid & Emergency Products. Designed to enhance accessibility and preparedness in various work environments, our products cater to individuals with mobility challenges and provide essential resources for emergency situations.

In times of unforeseen emergencies, our Emergency Products serve as vital tools for swift and effective response. Our inventory encompasses a diverse array of emergency supplies, including first aid kits, emergency evacuation chairs, fire extinguishers, and safety signage. These products are meticulously curated to equip workplaces with the necessary resources to address emergencies promptly and ensure the well-being of employees and visitors.



FLOOR SAFETY



Floor Safety is a critical aspect of workplace safety, and Safety Sasa is committed to providing products and services that mitigate the risks associated with potential hazards on floors. Our comprehensive range of offerings includes solutions designed to enhance traction, prevent slips, trips, and falls, and ensure a secure footing for workers and visitors alike.

We understand the importance of maintaining safe walking surfaces to minimize accidents and injuries. Our floor safety products encompass a variety of options, from non-slip floor coatings and mats to hazard signage and anti-fatigue flooring. Additionally, our expert consulting services can assist employers in identifying potential floor safety hazards and implementing effective preventive measures.

HEATERS

we extend our commitment to workplace safety to the category of heaters, ensuring that even in cold environments, employees remain protected and comfortable. Our heaters are carefully selected to meet the highest standards of safety and efficiency, providing reliable warmth without compromising on safety measures. From electric heaters to propane and natural gas options, our diverse range caters to various workplace needs



BATHROOM SAFETY

Bathroom Safety at Safety Sasa is dedicated to providing products and services tailored to safeguard individuals in one of the most common areas for accidents at home and in commercial settings. We offer a comprehensive range of bathroom safety equipment and solutions designed to minimize risks and promote well-being. From slip-resistant mats and grab bars to shower chairs and raised toilet seats, our products are aimed at enhancing safety and independence for users of all ages and abilities.



HYGIENE

Safety Sasa understands the critical importance of hygiene in maintaining a safe and healthy work environment. Our hygiene category encompasses a wide range of products and services designed to promote cleanliness and prevent the spread of germs and contaminants in the workplace.

From sanitation supplies such as hand sanitizers, disinfectants, and cleaning wipes to personal hygiene products like disposable gloves and face masks, our offerings are tailored to meet the diverse hygiene needs of businesses across various industries

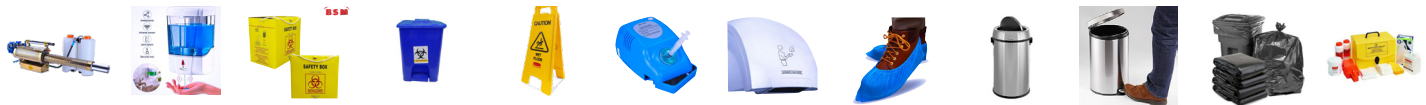

SWIMMING SAFETY

Our Swimming Safety category encompasses a variety of essential products and services tailored to enhance safety in swimming pools, beaches, water parks, and other aquatic venues. From personal protective equipment (PPE) such as life jackets, rescue tubes, and lifeguard whistles to water safety signage, first aid kits, and CPR training materials, we provide everything needed to mitigate risks and respond effectively in emergency situations.



HOME-CARE PRODUCTS



Our Home-Care Products category features essential items carefully curated to promote safety and well-being in your home environment. We offer a variety of other safety-enhancing products and services tailored to your home setting. Whether you're looking for childproofing solutions, fire safety equipment, or emergency preparedness kits, Safety Sasa has you covered.

LADDERS

At Safety Sasa, we understand the importance of ladders in preventing accidents and injuries in the workplace. Our wide selection of ladder safety products and services is designed to meet the diverse needs of various industries and workplaces.



OUTDOOR EQUIPMENTS

Discover a comprehensive selection of outdoor equipment tailored to meet your personal safety needs at Safety Sasa. Our range of outdoor gear encompasses essential items designed to protect you from hazards while working or enjoying recreational activities outdoors.

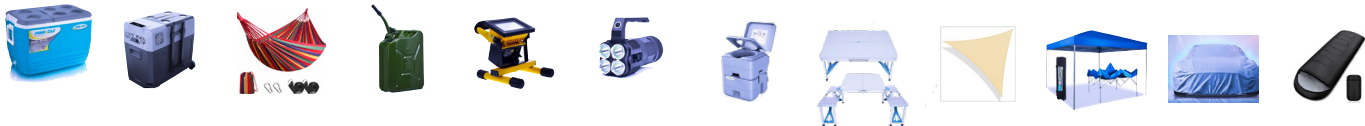

TRAVELING SET PRODUCTS



Safety Sasa offers a comprehensive range of traveling set products designed to ensure safety on the go. Our traveling sets include essential protective gear such as hard hats, safety glasses, earplugs, and respirators, tailored for professionals who work in dynamic environments or are frequently on the move.

A photograph of two workers in an industrial setting. The worker on the left is a man with a beard, wearing a yellow hard hat with 'SAFETY' written on it, safety glasses, and a high-visibility orange jacket with reflective silver stripes. He has large headphones around his neck and is smiling. The worker on the right is a woman with curly hair, wearing a red hard hat, safety glasses, and a high-visibility orange vest over a dark shirt. She also has large headphones around her neck and is smiling. The background is a blurred industrial environment with various pipes and machinery. The entire image is overlaid with a semi-transparent orange filter.

Business Documentations



No. **PVT-3QU7KA8B**

CERTIFICATE OF INCORPORATION

I hereby **CERTIFY** that,

SAFETY SASA LIMITED

is on this date 6 Feb 2023 Incorporated under the Companies Act, 2015 and that the Company is a **PRIVATE LIMITED COMPANY.**



.....
Registrar Of Companies

This is a system generated certificate. To validate this document send the word **BRS** to **21546**



PIN Certificate

For General Tax Questions
Contact KRA Call Centre
Tel: +254 (020) 4999 999
Cell: +254(0711)099 999
Email: callcentre@kra.go.ke

www.kra.go.ke

Certificate Date : 29/11/2023

Personal Identification Number

P052192197F

This is to certify that taxpayer shown herein has been registered with Kenya Revenue Authority

Taxpayer Information

Taxpayer Name	SAFETY SASA LIMITED
Email Address	safetysasaco@gmail.com

Registered Address

L.R. Number : NA	Building : CARGEN HOUSE
Street/Road : HARAMBEE AVENUE	City/Town : NA
County : Nairobi	District : Starehe District
Tax Area : CBD	Station : North of Nairobi
P. O. Box : 41587	Postal Code : 00100

Tax Obligation(s) Registration Details

Sr. No.	Tax Obligation(s)	Effective From Date	Effective Till Date	Status
1	Value Added Tax (VAT)	29/11/2023	N.A.	Active
2	Income Tax - Company	06/02/2023	N.A.	Active

The above PIN must appear on all your tax invoices and correspondences with Kenya Revenue Authority. Your accounting end month is December unless a change has been approved by the Commissioner-Domestic Taxes Department. The status of Tax Obligation(s) with 'Dormant' status will automatically change to 'Active' on date mentioned in "Effective Till Date" or any transaction done during the period. This certificate shall remain in force till further updated.

Disclaimer : This is a system generated certificate and does not require signature.



BUSINESS REGISTRATION SERVICE
P. O. BOX 30031
NAIROBI
6 FEB 2023

To
The Director(s)
SAFETY SASA LIMITED
P.O. Box 41587
00100 - G.P.O NAIROBI

THE COMPANIES ACT, 2015

Records relating to the below company held by the Companies Registry as at 6 Feb 2023

COMPANY	SAFETY SASA LIMITED
COMPANY NUMBER	PVT-3QU7KA8B
NOMINAL SHARE CAPITAL	100,000.00
NUMBER AND TYPE OF SHARES (VALUE PER SHARE)	ORDINARY: 100 (KES 1,000.00 EACH)
DATE OF REGISTRATION	6 FEB 2023
REGISTERED OFFICE	P.O BOX 41587, G.P.O NAIROBI TELEPHONE: +254717381554, EMAIL: SAFETYSASACO@GMAIL.COM COUNTY: NAIROBI, DISTRICT: STAREHE DISTRICT , LOCALITY: CBD STREET: HARAMBEE AVENUE, BUILDING: CARGEN HOUSE
POSTAL ADDRESS	P.O BOX 41587 G.P.O NAIROBI
ENCUMBRANCES	

Name of Directors and Shareholders of the above company with their particular are as follows

NAME	DESCRIPTION	ADDRESS	NATIONALITY	SHARES
GILBERT KIPTOO KURUI	DIRECTOR/SHAREHOLDER	P.O BOX 4198 NYAYO STADIUM	KENYA	ORDINARY: 25
MARTHA NJERI NJOROGE	DIRECTOR/SHAREHOLDER	P.O BOX 2487 NAKURU	KENYA	ORDINARY: 25
DANIEL KIPTISIA KIPKECH	DIRECTOR/SHAREHOLDER	P.O BOX 343 ELDAMA RAVINE	KENYA	ORDINARY: 50
TOTAL				100

Yours Faithfully,
REGISTRAR OF COMPANIES



REF NO: PVT-3QU7KA8B

DISCLAIMER: THIS IS A SYSTEM GENERATED CERTIFICATE AND DOES NOT REQUIRE A SIGNATURE



NAIROBI CITY COUNTY

SINGLE BUSINESS PERMIT

Effective Date: **12 January 24** Expiry Date: **11 January 25** Duration: **12 Months**

Nairobi City County grant this Business Permit to

Applicant / Business / Commercial Name: **SAFETY SASA LIMITED**

Permit ID: **SBP-D38D46AA** KRA Pin: **P052192197F**

To engage in the activity/business or occupation of **SUPLY OF GENERAL SUPPLIES AND SAFETY EQUIPMENTS.**

Activity Code: **830-Small retail / wholesale / distributors with up to 5 employees & or premises of up to 25sq. m- retail/wholesale distributor.**

Having Paid a business Permit Fee of KES: **15,000**

Amount in words *****Fifteen Thousand Shillings Only*****

Business under this permit shall be conducted at the address as indicated below

Sub County **STAREHE** Ward **C B D**

P.O Box: **PO BOX 35548** Plot No: **13544/10**

Road/Street: **QUEENSWAY HOUSE ALONG KAUNDA STREET, FL: 3, ROOM/DOOR: 317, SAFETY SASA SHOP**

Building: **D** By order of _____ Door/ Stall No: _____

-date of issue: 12 January 24



Notice: It is an offence to give false information. Granting this permit does not exempt the business identified above from complying and any other relevant laws and regulations as established by the Government of Kenya and Nairobi City County.





Tax Compliance Certificate

For General Tax Questions
Contact KRA Call Centre
Tel: +254 (020) 4999 999
Cell: +254(0711)099 999
Email: callcentre@kra.go.ke

www.kra.go.ke

Taxpayer PIN : P052192197F

Certificate Date: 16/04/2024

Name and Address :

SAFETY SASA LIMITED

NA, CARGEN HOUSE, NA, Starehe District,
PO Box:41587,
Postal Code:00100

Certificate Number:

KRANON1392586824



**This is to confirm that SAFETY SASA LIMITED,
Personal Identification Number P052192197F
has filed relevant tax returns and
paid taxes due as provided by Law.**

**This Certificate will be valid for
twelve (12) months up to 15/04/2025.**

Caveat: This certificate is issued on the basis of information available with the authority as at the certificate date mentioned above. The Authority reserves the right to withdraw the certificate if new evidence materially alters the tax compliance status of the recipient.

Disclaimer : This certificate is system Generated and therefore does not require signature. You may confirm validity of this certificate on the iTax Portal by using the TCC Checker. This certificate confirms your compliance status for a period of five years preceding the date of issue. The certificate may however be with withdrawn on grounds of outstanding debt affecting periods prior to this.

Directors' Identification

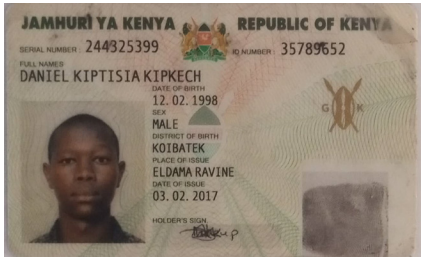

Daniel Kiptisia

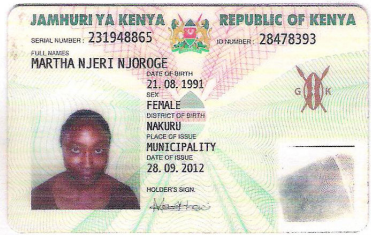
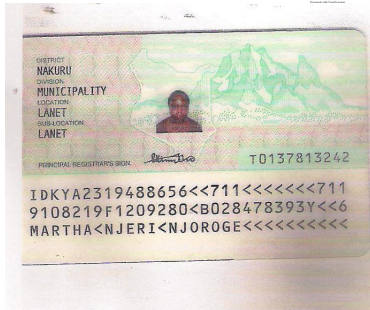

Martha Njeri



Gilbert Kiptoo

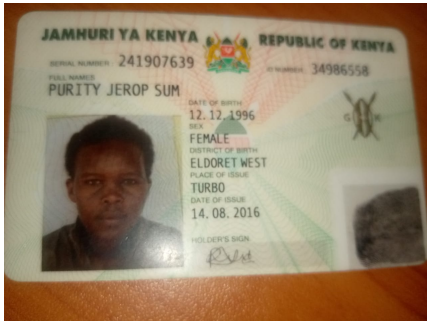

Purity Jerop



KCB Bank Kenya Limited
Biashara Street Branch
P.O. Box 45422 – 00100
Nairobi, Kenya
Tel: +254 711 087 000
SMS: 22522
Email:
biashara.kcb.co.ke

Wednesday, September 25, 2024

To,

Whom It May Concern.

'WITHOUT PREJUDICE'

Dear Sir/Madam,

RE: SAFETY SASA LIMITED KES AC. NO.1313185809.

We confirm that the above mentioned operates the listed account in our books.

The bank account details are as follows.

Account Name: SAFETY SASA LIMITED
Account Number: 1313185809
Bank: KCB Bank Kenya Limited
Swift Code: KCBLKENX
Bank Code: 01
Branch Code: 263

We have had no cause to enquire into the director's private financial means. However, in the event that we receive a duly executed request for financing, we shall appraise the same subject to standard bank requirements on financing.

This information is communicated to you in strict confidence and without any liability, pecuniary or otherwise on the part of the bank or any of its officials.

Yours faithfully,

DOUGLAS NYAMONGO
BRANCH MANAGER

POB: KCB BANK KENYA LTD.
Branch Manager
BIASHARA STREET, NAIROBI

Purchase Orders & Invoice



PURCHASE ORDER

DATE	25-Sep-2024
PO #	652
QUOTAION/PI	05282Q
CATEGORY	PRODUCTION

Elecster Kenya Limited
 Kay Complex Godowns A4
 LR NO. 20258 Industrial Area off Mombasa Road
 NAIROBI
 PIN NO. P051649305K
info@elecster.co.ke
 Tel. 0202633258

VENDOR

SAFETY SASA LIMITED
 P.O.BOX 35548-00100 NAIROBI
 Queensway House, Along Kaunda Street 317
safetysasa@gmail.com
 0719 409 924

ITEM #	DESCRIPTION	QTY	UNIT PRICE	TOTAL
1	Expandable Safety Barrier 1Mx3M	2.00	13,500.00	27,000.00
2	Reflective Adhesive Tape for floor marking 4"x50M (3M)	10.00	2,800.00	28,000.00
3	Lorry Seals	100.00	21.550	2,155.00
4	Delivery	1.00	862.070	862.07

Comments or Special Instructions	SUBTOTAL	58,017.07
	16% VAT	9,282.73
	TOTAL KES	67,299.80

Usage: Safety barrier for the highly flammable substances, floor marking reflective tape, Seals for sealing lorries when dispatching orders

Prepared & Approved by:
 Linet Kiambi
 Procurement Manager

Approved by: Ljubov Grigorieva
 Executive Director

Company Stamp



Forecasted Usage Duration:

Purchase Orders & Invoice



CONTRACT PURCHASE ORDER

Date: 24.09.2024

WISEe Address

Women In Sustainable Energy and Entrepreneurship
 (WISEe) Co-op Society Ltd
 P. O Box 9634 – 00300, Nairobi, Kenya
 Email: info@wiseafrica.org
 Phone: +254 769 465 912
<https://wiseafrica.org>

Vendors Name	Safety Sasa Limited
KRA Pin No	
Email Address	Safetysasake@gmail.com
Phone No	0719409924
Ref No	Wisee007

Supply the below Service(s);

Description	Unit	Quantity	Frequency	Unit Cost	Total
	Package		Days		
1. Medium Duty Racking 3 beam levels 220kgs per level H 2500MM 2000D500MM		2	1	52,200/=	104,400/=
2. Delivery Fee					2,000/=

(As per your quotation via email)

Note: Prices included of all taxes as per your quotation Offer

Total Amount: KES 106,400.00

DELIVERY TIME

Delivery of goods/Services within 14 days from the day of contract.

QUALITY

WISEe has a right to reject any deliverables which differ from the approved offer quote.

DOCUMENTS REQUIRED FOR PAYMENT

1. Signed and Stamped Invoice and Delivery note
2. Attested Packing List
3. Bank Details.

Order Placed By: Name & Designation Sign

Approved by:

Name	Designation	Signature



Vendor Acceptance:

Title SAFETY SASA LTD

Account Name:	SAFETY SASA LTD
Account Number:	1212185809
Bank & Branch:	KCB BANK BIAHARA STREET

NOTE: Vendor to carefully read contract conditions attached to this Local Purchase Order and by appending the signature the vendor accepts to observe all the conditions without exception.

Vendor Contract Agreement with Women In Sustainable Energy and Entrepreneurship(WISEe)

2. Vendor Agreement

This Vendor Agreement is between the vendor (whose full name and address) are contained in this agreement and WISEe for the period stated herein. This agreement can be cancelled by either party upon written notice.

3. Contract Purchase Order (CPO)

This is the official commitment from WISEe for the supply of goods or services. The CPO MUST be signed by an authorized WISEe officer. Upon receipt of an original CPO, the Vendor will deliver the items or services within the stated time in the CPO. If unable to supply, WISEe requires immediate notification of the proposed delivery date.

4. Prices

4.1 The Vendor is required to provide items or services as per the price list provided on the original bid documentation. In instances where the prices are not known, WISEe will provide the vendor with a copy of Purchase Request which lists the items to be purchased. Upon receipt of the Purchase request, the vendor will provide Proforma Invoice so as to include the prices on the CPO.

4.2 If items are not available at the time the Proforma Invoice is prepared, WISEe must be notified so that items are not included in the CPO.

4.3 If you are VAT compliant attach ETR receipt to the invoices.

5. Deliveries

5.1 Unless otherwise directed, the vendor is to deliver the goods or services to the WISEe location indicated in the CPO. The deliveries must be within the contractual framework for delivery.

5.2 At the time of delivery, the Vendor is required to do the following: # Deliver the items as agreed upon in the CPO

Provide a Delivery Note that has an itemized list of the goods or services delivered.

Provide an invoice that has an itemized list of the goods or services delivered and the total price. # Note that no payment will be made without meeting the requirements highlighted in #4.

6. Vendor payments

Payment of the invoices will be made via a cheque or funds transfer within three months of full delivery.

7. Professional Conduct

7.1 As a WISEe Vendor, you are expected to ensure that the following does not occur:

Unethical conduct or unprofessional behavior by the Vendor or vendor's agents. This would include, but not limited to, trying to obtain privileged information about competitor's prices, quotes etc.

Offering of kickbacks, bribes, inducements or payments to WISEe staff or representatives. # Providing poor service, low quality products or non-adherence to the agreement.

WISEe holds ethical conduct in the highest regard. If it is discovered that corrupt or unethical practices have been undertaken by the vendor, or attempted, the Vendor will be disqualified from any further work with WISEe.



MANDATORY TO BE FILLED	
Vendor Acceptance Agreement	
I hereby confirm that I have read the terms and condition appearing on both pages of this CPO/LPO and Express our/my acceptance that we/I will abide by them.	
Name:	Daniel Kiptisid Kiplesh 35789654
Title:	M. Director

Purchase contract

Demander: Fullicare (Kenya) Medical
Tel: 0798617008 **Fax:** _____
SAP: 4300055819 **Supplier:** SAFETY SASA LIMITED
Purchaser's signature (see): _____ **Delivery address:** Fullicare (K) Medical SEZ Ltd, Kiambu Rd,
 Tatu City Industry Park, P. O. BOX 43446-00100, NAIROBI. **Contract person:** DANIEL
Supplier's signature (seal): _____ **Tel:** _____

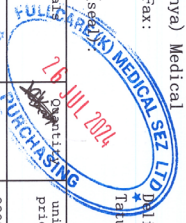

#	Order Number	Materials	Quantity	Unit price	Unit price including tax	Batch number	Production date	Expiration date	Quality requirements	Print version	Inspection standard number	Delivery date	QR code expiration	Barcode expiration
10		W4019LCKRSTLCBT/9 locker steel cabinet	3PCS	33850	33850							2024.07.26		
20		W40115LCKRSTLCBT/15 locker steel cabinet	1PCS	49000	49000							2024.07.26		
30		W401FLCGBT/Flle cabinet	1PCS	28000	28000							2024.07.26		
40		W401FRSTGLSFM12MB5 OM/ Frosted Glass Film 1.2M width by 50M	2PCS	46500	46500							2024.07.26		

Purchase contract

50	W401WTATMSPYPT/White Automatic Spray Paint	201	700	700								2024.07.26		
60	W401YLWFLSTPT/Yellow Fluorescent Paint	8BEI	4500	4500								2024.07.26		
70	W401PTBRSH/Paint Brush	10PCS	260	260								2024.07.26		
80	W401CLRSRTPPPRTP/COLOR Separation Paper Tape	100PCS	150	150								2024.07.26		



Total amount including tax£° (KES) :339150.00

1. Delivery location: The supplier is responsible for delivering the goods to the warehouse designated by the buyer and bears the transportation costs.
2. Delivery requirements: The supplier must fill in the delivery list when delivering the goods, and indicate the SAP number, material code, material/product name, quantity and specification and other details, and provide samples of various specifications according to the requirements of the buyer for test.
3. Payment method:
4. Quality requirements:
 - 1) The quality of materials/products required by the buyer must comply with the company standards of the buyer and relevant international national standards and industry standards. If any loss is caused by quality problems, the supplier must bear all the losses at the same time.
 - 2) The supplier shall provide the product inspection report.

Purchase contract

- 3) If the material/product is found not to meet the requirements of the buyer after inspection, the product will be returned unconditionally in principle, and the qualified product will be returned within the specified time; if the two parties agree to use it through selection, etc.
5. Quantity requirement: The supplier must ensure that the delivery quantity is consistent with the quantity on the delivery list. If the purchaser finds a shortage in the quantity during the sampling process, it will be deducted from the entire batch of delivery quantity according to this ratio.
6. Packaging requirements:
 - 1) The supplier must ensure the integrity and safety of the product when delivered to the purchaser.
 - 2) The markings on the packaging must be clearly marked as required by the purchaser, otherwise the purchaser has the right to refuse.
 7. The supplier shall deliver the goods on time as required by the purchaser, and 2% of the payment for the batch shall be deducted for one day of delayed delivery, and so on, with a cumulative amount not exceeding 10%.
 8. When the supplier receives this contract, they must sign and stamp it for confirmation within 8 hours, otherwise it will be deemed that the supplier has confirmed and accepted this contract.
 9. Method of resolving contract disputes: If any disputes arising from this contract cannot be resolved through consultation between both parties, either party has the right to submit the dispute to the people's court in the place where the demander is located.
 10. Intellectual Property: The supplier shall ensure that the trademarks, patents, and other intellectual property rights of the goods provided belong to the supplier. For goods that are not owned by the supplier, the supplier is obligated to provide formal channel proof to the demander. The supplier is obligated to keep confidential the technical data, drawings, and other related information and quality information provided by the demander.





SAFETY SASA LIMITED.
QUEENSWAY HOUSE ALONG KAUNDA STREET 317
P.O BOX 35548 00100.
0719409924/0717381554
safetysasake@gmail.com

QUOTATION

QUOTE TO FULLCARE MEDICAL

QUOTE NUMBER 052258Q

Date 24/7/2024

Description	Quantity	Unit price	Amount
9 LOCKER METALLIC OFFICE CABINET	3	Ksh 33,850.00	Ksh 101,550.00
15 LOCKERS LOCKER OFFICE CABINET	1	Ksh 49,000.00	Ksh 49,000.00
FILE CABINET	1	Ksh 28,000.00	Ksh 28,000.00
FROSTED GLASS FILM 1.2M WIDTH BY 50M ROLL	2	Ksh 46,500.00	Ksh 93,000.00
WHITE AUTOMATIC SPRAY PAINT 500ML	20	Ksh 700.00	Ksh 14,000.00
YELLOW FLUORESCENT PAINT 4L	8	Ksh 4,500.00	Ksh 36,000.00
3INCH PAINT BRUSH	10	Ksh 260.00	Ksh 2,600.00
2CM SEPARING PAPER TAPE 25M LENGTH	100	Ksh 150.00	Ksh 15,000.00
Total			Ksh 339,150.00
VAT			Ksh 0.00
TOTAL AMOUNT			Ksh 339,150.00

PAYMENT OPTIONS.

MPESA.

LIPA NA MPESA.

BUYGOODS:

TILL NO:8464244

PAYBILL: 522522

ACCOUNT NO: 1313185809

BANK.



ACCOUNT NAME : SAFETY SASA LIMITED.
ACCOUNT NUMBER : 1313185809.
ACCOUNT BRANCH : KENYA COMMERCIAL BANK (BIASHARA STREET)

SAFETY SASA LIMITED.

Your Safety is Our Business



Purchase Orders & Invoice



SAFETY SASA LIMITED.
QUEENSWAY HOUSE ALONG KAUNDA STREET 317
P.O BOX 35548 00100.
0719409924/0717381554
safetysasake@gmail.com

INVOICE

BILL TO DIAMOND OAK RESIDENCY
 LAVINGTON

INVOICE NUMBER 05260V
Date 31/7/2024

Description	Quantity	Unit price	Amount
660L GREEN DUSTBIN WITH WHEELS	3	Ksh 65,000.00	Ksh 195,000.00
Total			Ksh 195,000.00
			Ksh 0.00
TOTAL AMOUNT			Ksh 195,000.00

PAYMENT OPTIONS.

MPESA.

LIPA NA MPESA.
BUYGOODS:
TILL NO:8464244

PAYBILL: 522522
ACCOUNT NO: 1313185809

BANK.

ACCOUNT NAME : SAFETY SASA LIMITED.
ACCOUNT NUMBER : 1313185809.
ACCOUNT BRANCH : KENYA COMMERCIAL BANK (BIASHARA STREET)

SAFETY SASA LIMITED.

Your Safety is Our Business



Purchase Orders & Invoice

KEMA (E.A) Limited
Off Shima La Tewa Road

PO Box 76651-00508

Nairobi

VAT No. **0027256M**
Telephone **0720821970**
0734600867

E-mail kema@kema.africa

Website <http://www.kema.africa>

o:
AF009
AFETY SASA LIMITED

Date 23-05-2024

Order No PO4489

<u>em Code</u>	<u>Item Description</u>	<u>Quantity</u>	<u>Unit</u>	<u>Price (Ex)</u>	<u>Disc %</u>	<u>Tax</u>	<u>Total (Incl)</u>
03D008	Safety Crocs	4.00		2,350.00		1,504.00	10,904.00
03D009	Safety Crocs	5.00		2,350.00		1,880.00	13,630.00
03D010	Safety Crocs	5.00		2,350.00		1,880.00	13,630.00

- . This order may be cancelled if not supplied as per specification
. All goods bought are subject to our count, inspection and test, all services subject to our approval
. Goods that do not pass our inspection may be returned or held or resold subject to adjustment.
. This order must not be changed in any way without authority of Managing Director
. Please quote our LPO on both the delivery note and the invoice

Total (Excl)	32,900.00
Tax	5,264.00
Total (Incl)	38,164.00
Discount	0.00
Total (Incl)	38,164.00

Prepared by Gideon

Date _____

Signed _____



SAFETY SASA LIMITED.
QUEENSWAY HOUSE ALONG KAUNDA STREET 317
P.O BOX 35548 00100.
0719409924/0717381554
safetysasake@gmail.com

INVOICE

BILL TO GRAND HEIGHTS LTD

INVOICE NUMBER 0574V

Date 04/05/2024

DIAMOND OAK RESIDENCY OTHAYA ROAD

Description	Quantity	Unit price	Amount
660L GREEN DUSTBIN WITH WHEELS	3	Ksh 62,000.00	Ksh 186,000.00
Total			Ksh 186,000.00

PAYMENT OPTIONS.

MPESA.

LIPA NA MPESA.

PAYBILL: 522522

ACCOUNT NO: 1313185809

BANK.

ACCOUNT NAME : SAFETY SASA LIMITED.

ACCOUNT NUMBER : 1313185809.

ACCOUNT BRANCH : KENYA COMMERCIAL BANK (BIASHARA STREET)

SAFETY SASA LIMITED.

Your Safety is Our Bussiness

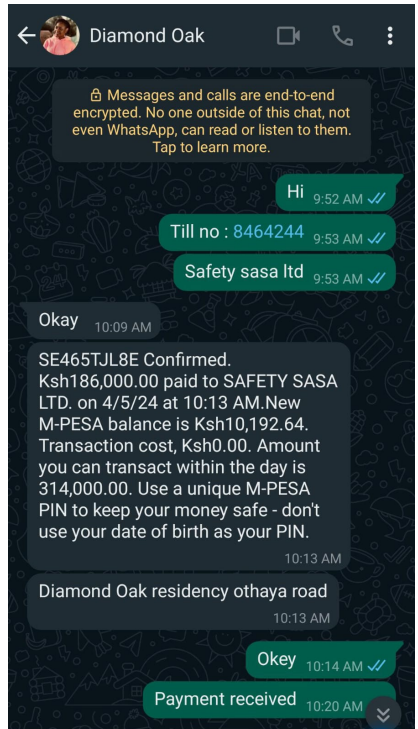

Contact Us

— Call —

0719 409 924 | 0790936744

— Email —

Safetysasake@gmail.com

Location

Queensway house along
Kaunda street 3rd floor

Website

www.safetysasa.com

